

Orangethorpe

Transit Village Study

Reimagining the OCTA Fullerton Park and Ride Facility

Online Community Webinar

October 22, 2024

Welcome! We will begin in a few moments.
¡Bienvenido! Comenzaremos en unos momentos.
환영합니다! 잠시 후에 시작하겠습니다.



Interpretation Available / Interpretación Disponible

- Click on the “Interpretation” icon
- Select your language of choice "English", "Spanish", or "Korean"
- To hear Spanish or Korean interpretation only, click Mute Original Audio



Spanish

- Haga clic en el icono de “Interpretación”
- Seleccione “Spanish” (español)
- Para escuchar solo el idioma interpretado, haga clic en “Mute Original Audio” para “Silenciar el audio inglés”

Korean

- '해석' 아이콘 클릭
- "한국어"를 선택합니다
- 한국어 번역만 들으려면 "오리지널 오디오 음소거"를 클릭합니다



Meeting Format

Today's meeting is being recorded to accurately capture your input.

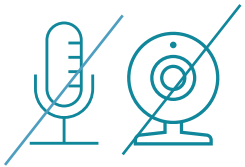

Attendee cameras are off and microphones are muted.

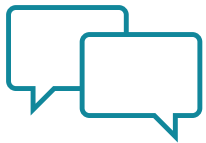

Questions can be submitted throughout the presentation using the 'Q&A' function. The team will respond to questions during the Q&A sessions.



To use closed captioning, select the "cc" at the bottom of your Zoom screen



Please use the '*Raise Hand*' icon to ask a question verbally during the 'Q&A' sessions.

How to Participate

You may submit multiple comments/questions, as needed:

Via web

- Verbal Comments: Click Participants > “**raise hand**”
- Type comments: Click the “**Q&A**” function
- State your name and organization (if any)
- When announced, unmute your audio, you can then ask you question(s)
- You will be re-muted once you complete your comment(s)



Via the phone (calling in):

- Press “*9” on your keypad to “raise hand”
- You will be announced by the last four digits of your phone number
- Press “*6” to unmute your audio
- You will be re-muted once you complete your comment(s)

As a reminder, the chat will be used by the team to share information and links to resources.

Today's Speakers



Angel Garfio
Project Manager

Marissa Espino
Public Outreach Section Manager



Jaymes Dunsmore
Project Manager



Team Introductions

Lead Agency



Partners



Consultant Team



Urban Planner



Community Outreach



Agenda

6:05 PM **Presentation** (with feedback questions throughout)

- Study Overview
- Study Tasks & Timeline
- Initial Observations
- Transit Village Examples
- Community Outreach

6:30 PM **Q&A**

7:00 PM **Adjourn**



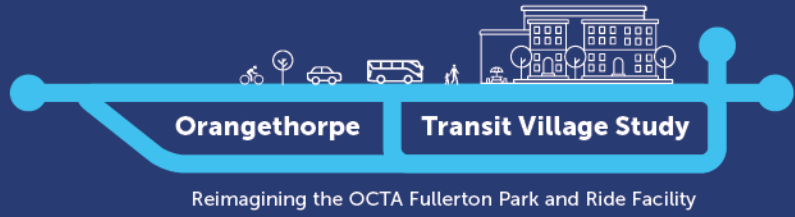

Study Overview

Site Overview

OCTA Fullerton Park and Ride
3000 W Orangethorpe Ave
Fullerton, CA 92833

- Owned & operated by OCTA
- ~ 9 Acres
- 8 Bus Routes (25, 26, 30, 33, 35, 83, 529 & 460 (Metro))
- 14 Bus Bays and
- 2 On-street Bus Stops
- 745 Parking Spaces



Study Goals

Study potential improvements and transit-supportive development opportunities at the OCTA Fullerton Park and Ride facility.

- Create a Transit-Supportive Mixed-Use Development
- Enhance Transit and Park and Ride Facilities
- Improve Transit Rider Experience
- Increase Access to Sustainable Mobility
- Strengthen Community Pride and Sense of Place



Study Name

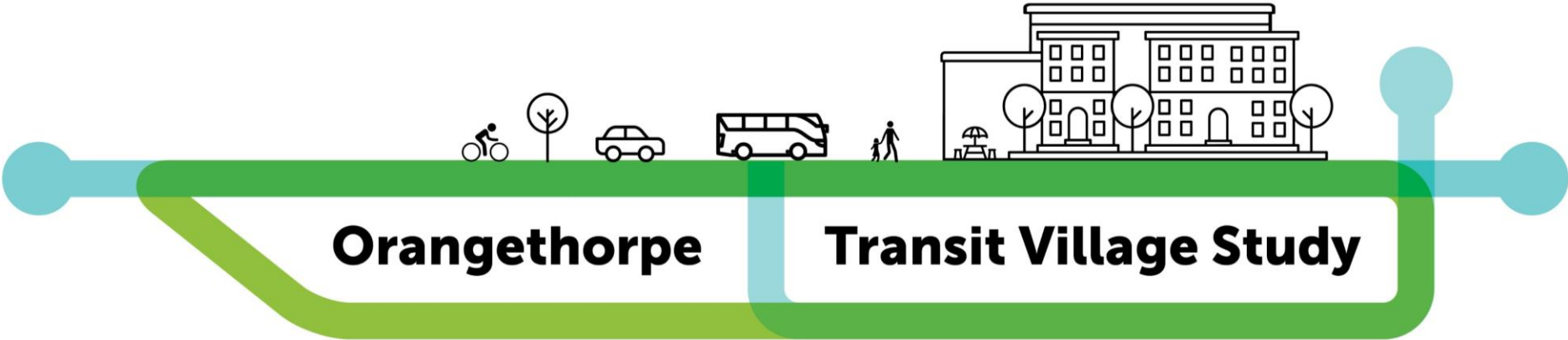

Reimagining the OCTA Fullerton Park and Ride Facility



Zoom Poll Question #1:

What is your connection with the Fullerton Park and Ride?



Select a choice in the pop-up Zoom poll:

- A – I am a nearby resident
- B – I work close to the site
- C – I use the OCTA bus facility
- D – I use the parking for surrounding destinations
- E – I have no connection to the site

Other? Add your answer to the chat.



Zoom Poll Question #2:

How do you usually get to the Park and Ride?



Select a choice in the pop-up Zoom poll:

A – I walk

B – I ride my bike

C – I drive my car

D – I take the bus

E – I use rideshare (Uber, Lyft)

F – I get dropped off by my family or friends

G – I use a scooter or skateboard

H – I don't use the Park and Ride

Other? Add your answer to the chat.



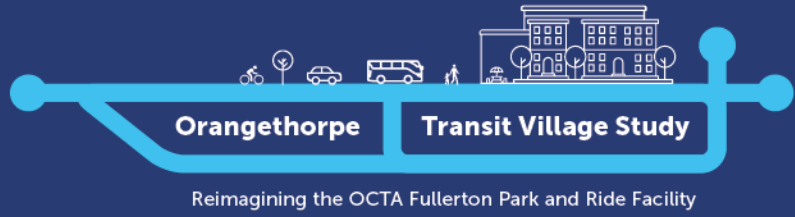

Study Tasks & Timeline

Timeline

We are here!

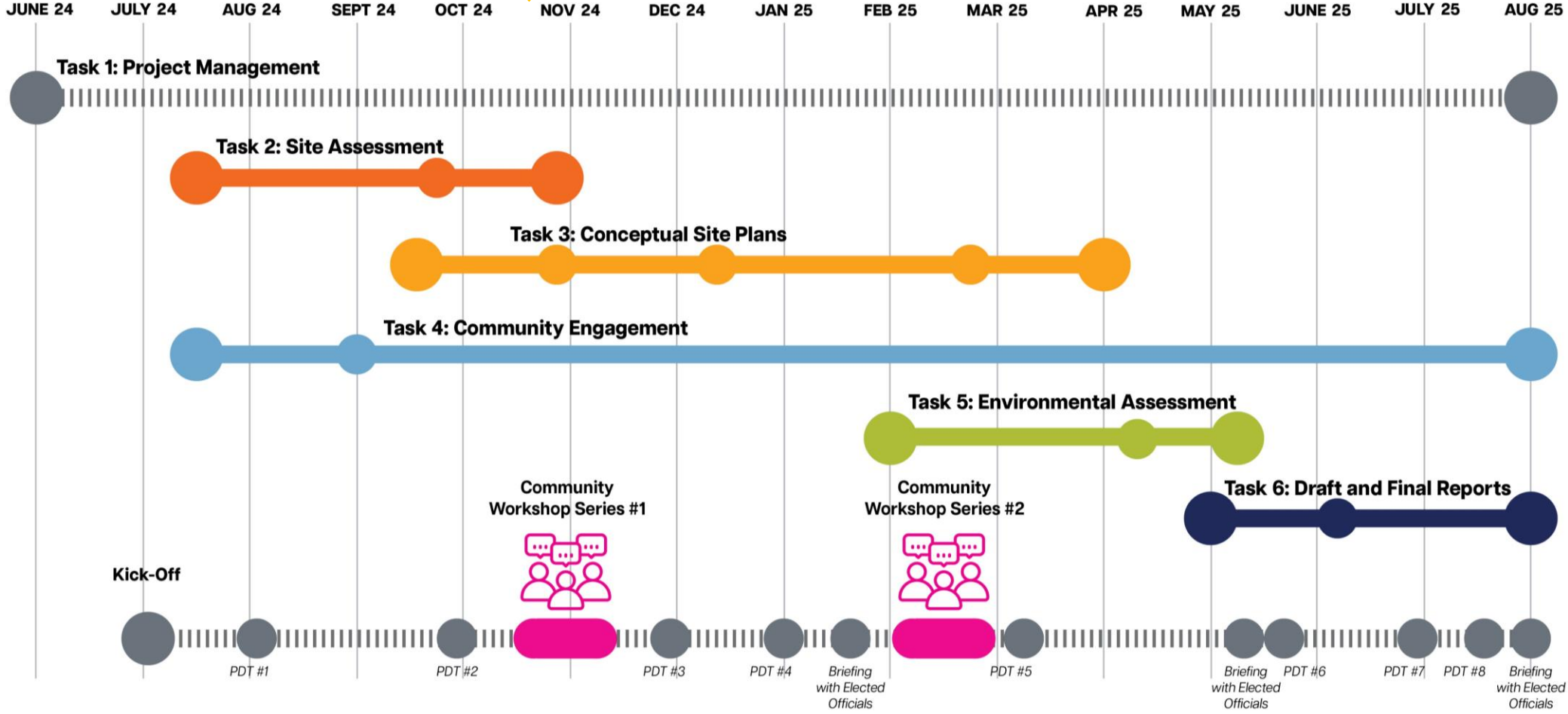

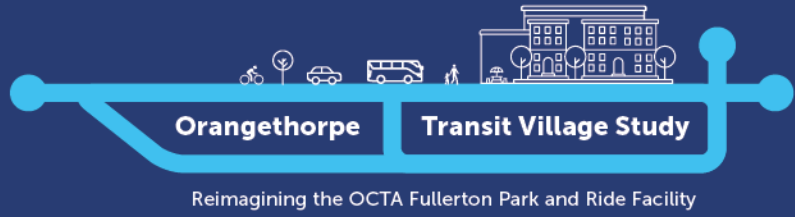

Initial Observation s

The Site Today

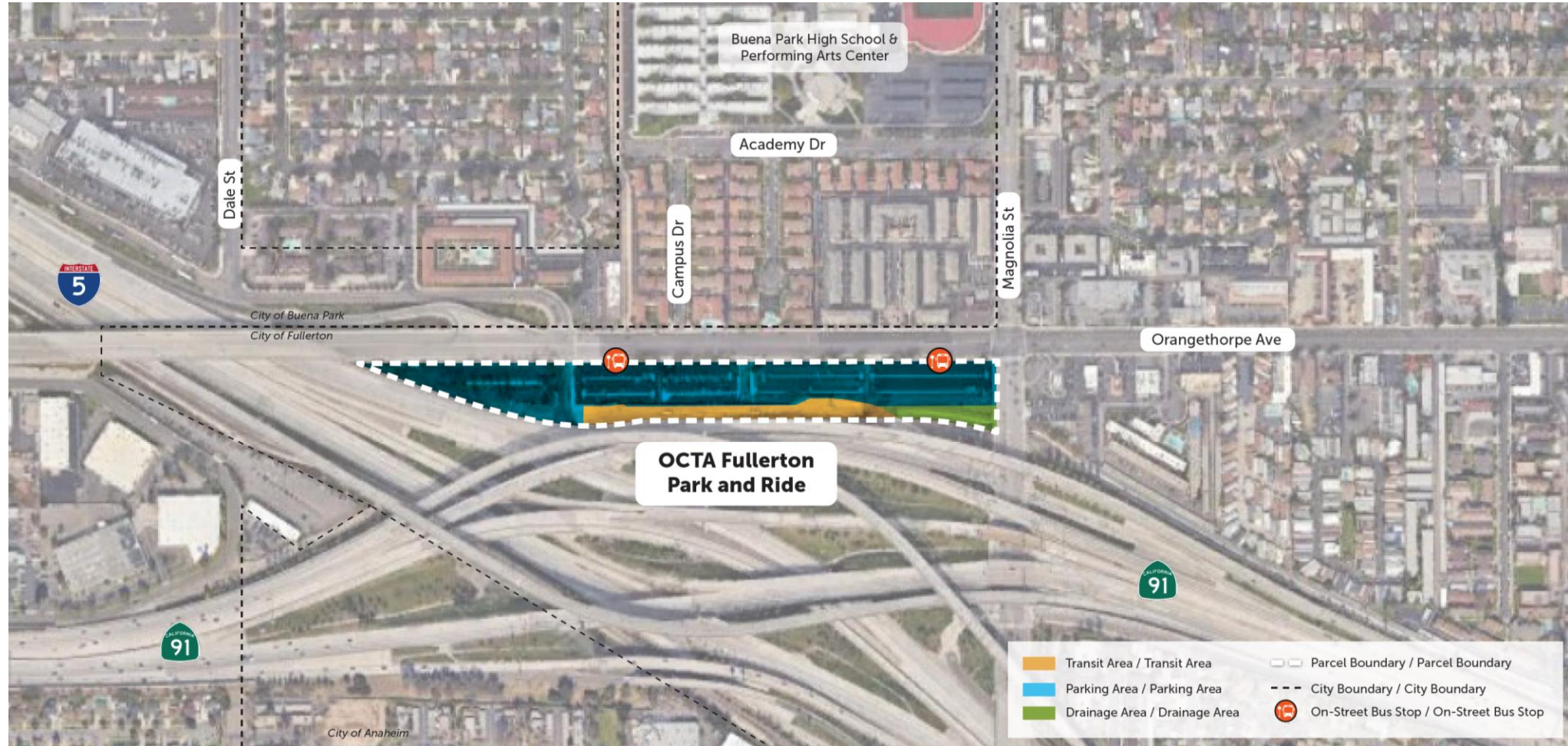

Challenges

- Freeway Noise & Adjacency
- Pedestrian & Bike Access
- Lack of Amenities
- Utilities
- Flood Control Channel



Opportunities

- High Visibility from Orangethorpe and Magnolia
- Transit Services
- Excess Parking Area
- Vehicular Access
- Proximity to Schools and Residential Neighborhoods



Zoom Poll Question #3:

What improvements would you most like to see at the Fullerton Park and Ride?



Select your top three (3) in the Zoom Poll:

- A – More shade (trees, shade canopy)
- B – Enhanced security measures
- C – Improved street crossings
- D – Better lighting in the evenings
- E – More activities while waiting for the bus

- F – More comfortable seating
- G – Improved bathroom facilities
- H – Secure bike parking
- I – Bike repair station
- J – Electric vehicle (EV) / E-bike charging

Other? Add your answer to the chat.





A

More shade (trees, shade canopy)



B

Enhanced security measures



C

Improved street crossings

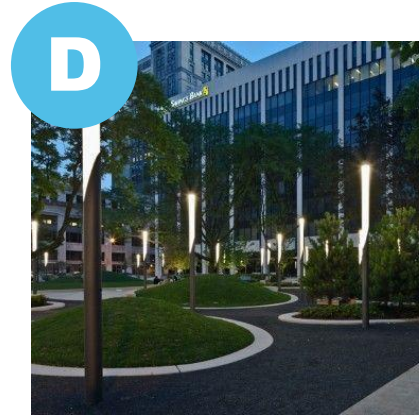

D

Better lighting in the evenings



E

More activities while waiting for the bus



F

More comfortable seating



G

Improved bathroom facilities

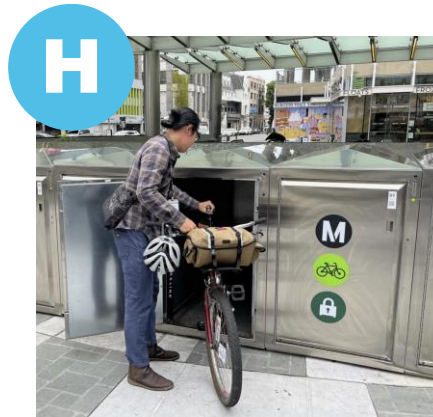

H

Secure bike parking



I

Bike repair station



J

Electric vehicle (EV) / E-bike charging



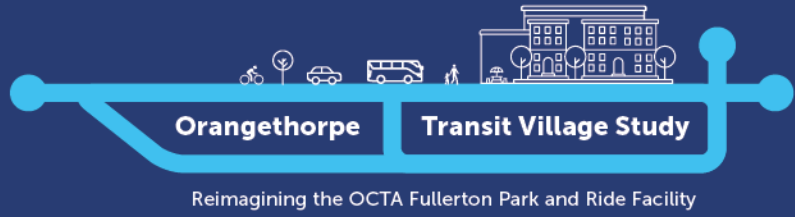

Transit Village Examples

What is a Transit Village?

Transit-oriented development (TOD) is a planning strategy that focuses on building mixed-use, pedestrian-friendly communities around public transit.

TODs are designed to be compact and integrated with mass transit and can include a variety of uses such as commercial, residential, office, and retail.

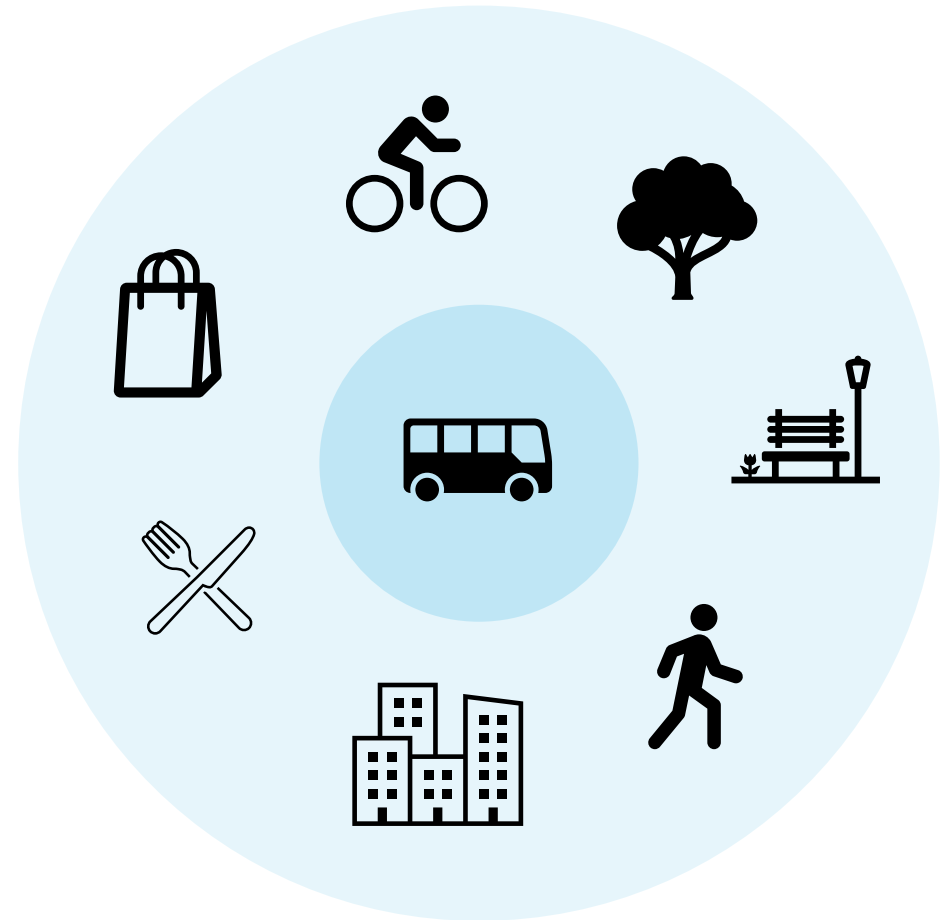

Ivy Station, Culver City, CA

- Adjacent to Metro Station
- Ground floor includes restaurants, shops and services.
- 5-6 stories of housing, offices, and hotel above
- Central open lawn with water feature and programmable space for community events



Pacific Station, Santa Cruz, CA

- Adjacent to bus facility
- Ground floor includes restaurants, shops and services
- 5 stories of housing above
- Central pedestrian walkway provides access to transit center



Othello Square, Seattle, WA

- Adjacent to transit facility
- Ground floor includes a children's health clinic and child development center
- 5 stories of affordable, workforce and market rate housing above
- Façade features public art installations



Zoom Poll Question #4:

If transit-oriented development were considered for the Fullerton Park and Ride, what transit-supportive uses would you most like to see?



Select your top three (3) in the Zoom Poll:

A – Housing

B – Office

C – Hotel

D – Retail Shops, Restaurants, and Services

E – Open Space (plazas, parks)

F – Community Events

Other? Add your answer to the chat.





A

Housing – Ex. Othello Sq, Seattle, WA



B

Office – Ex. The Habitat, Los Angeles, CA

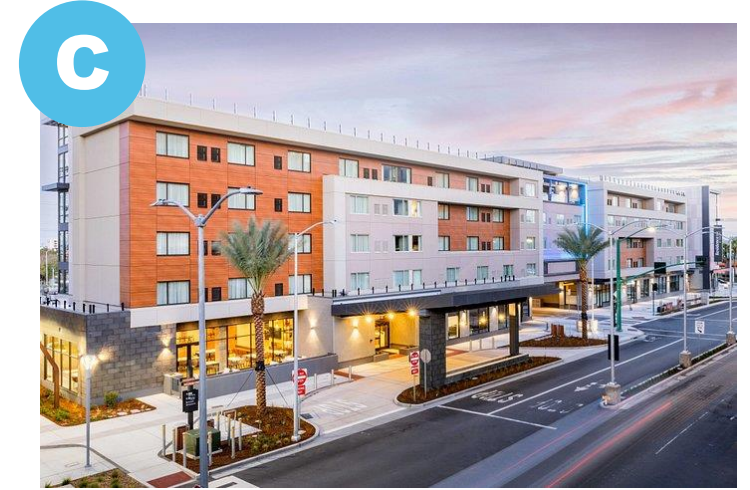

C

Hotel – Ex. Millbrae Station, Millbrae, CA



D

Retail, Shops & Restaurants – Ex. Pacific Station, Santa Cruz, CA

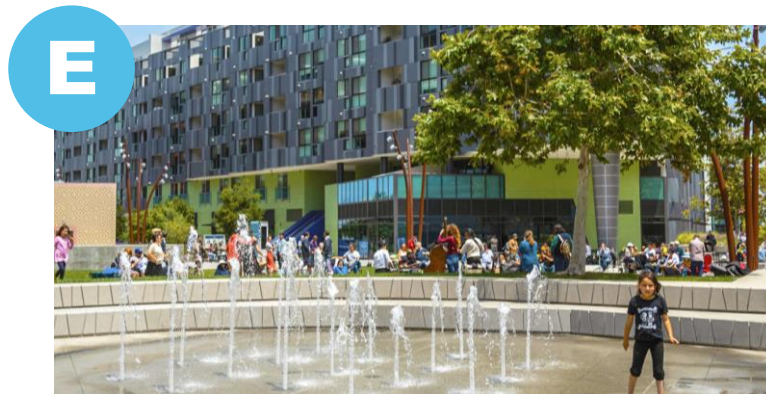

E

Open Space – Ex. Ivy Station, Culver City, CA



F

Community Events – Ex. Capitol Hill TOD, Seattle, WA



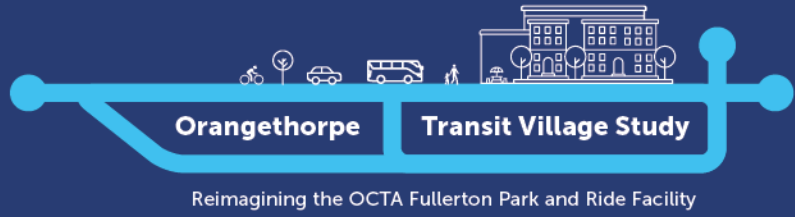

Community Outreach

Public and Stakeholder Engagement

Phase I: Trilingual Notification: Sept. 30th to Nov. 10th

Notification Efforts

- Project website
- Mailer/flyers
- Door-to-door notification
- Electronic notices
- Social media ads
- Public counter notification distribution
- Lawn signs
- E-communications toolkit
 - Sent to partners, stakeholders & community groups

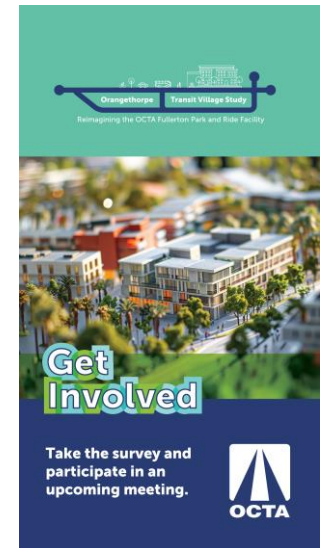

Public and Stakeholder Engagement Cont.

Phase I: Trilingual Notification: Sept. 30th to Nov. 10th

Engagement Activities:

- Events and Pop-ups
- Virtual Meeting
- Two in-person meetings
- Multilingual online and print survey



sur-vey.typeform.com/FullertonPNR



How to Stay Involved

- Take our survey and attend our meetings

Take our Survey!

- Win one of two \$50 prize cards!
- Deadline: Nov. 10th



In-person Community Meeting #3

**Thursday, Oct 24th
6:00 PM – 8:00 PM**

Buena Park High School

Stay Connected

- Website: www.octa.net/FullertonPnR
- Online Survey: bit.ly/Fullerton-PnR-Survey

Marissa Espino

Public Outreach Section Manager

Mespino@octa.net

Angel Garfio

Project Manager

agarfio@octa.net

Scan the QR to take our survey!



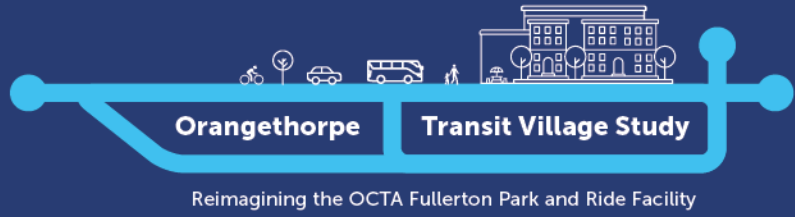

Q&A Session

How to Participate

You may submit multiple comments/questions, as needed:

Via web

- Verbal Comments: Click Participants > “**raise hand**”
- Type comments: Click the “**Q&A**” function
- State your name and organization (if any)
- When announced, unmute your audio, you can then ask you question(s)
- You will be re-muted once you complete your comment(s)



Via the phone (calling in):

- Press “*9” on your keypad to “raise hand”
- You will be announced by the last four digits of your phone number
- Press “*6” to unmute your audio
- You will be re-muted once you complete your comment(s)

As a reminder, the chat will be used by the team to share information and links to resources.

Next Steps

- **Solicit Public Stakeholder Input & Analyze Survey Results** – Fall 2024
- **Conceptual Site Plans** – Mid Spring 2025
- **Community Workshop Series #2** – Mid Spring 2025
- **Preliminary Environmental Assessment** – Late Spring 2025
- **Final Report** – Late Summer 2025



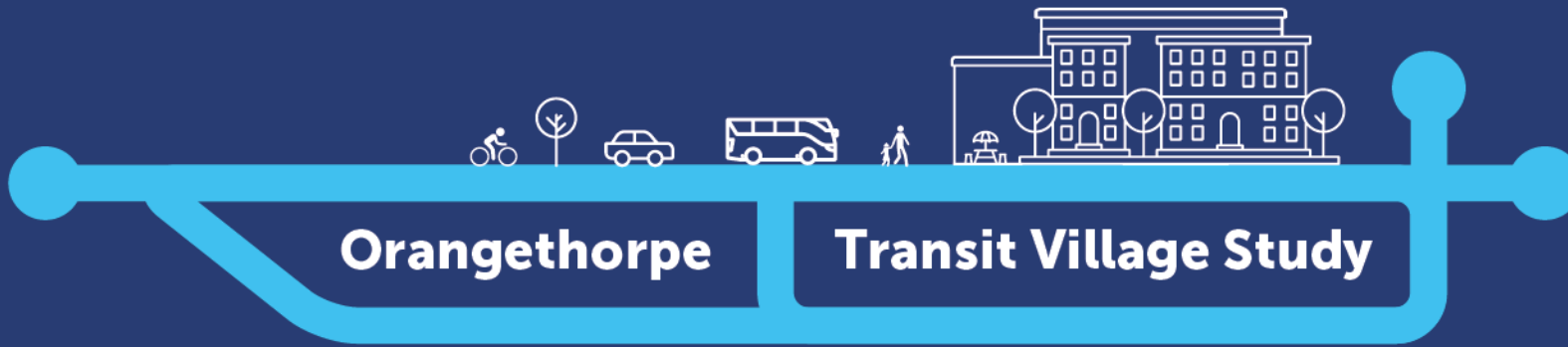

Orangethorpe

Transit Village Study

Reimagining the OCTA Fullerton Park and Ride Facility

Thank you!

