



*Citizens Advisory Committee
Bicycle/Pedestrian Subcommittee*

March 15, 2016



Project Area



Map provided for general reference only. Not to scale.



The Purpose

Address existing and future traffic demand:

1. Increase capacity on freeway
2. Increase capacity on ramps
3. Improve freeway operations and ITS elements
4. Enhance safety

Goal: Minimize environmental impacts & ROW needs

Project Limits & Area of Improvements



Interstate 405 Improvements Project from Interstate 5 to SR-55

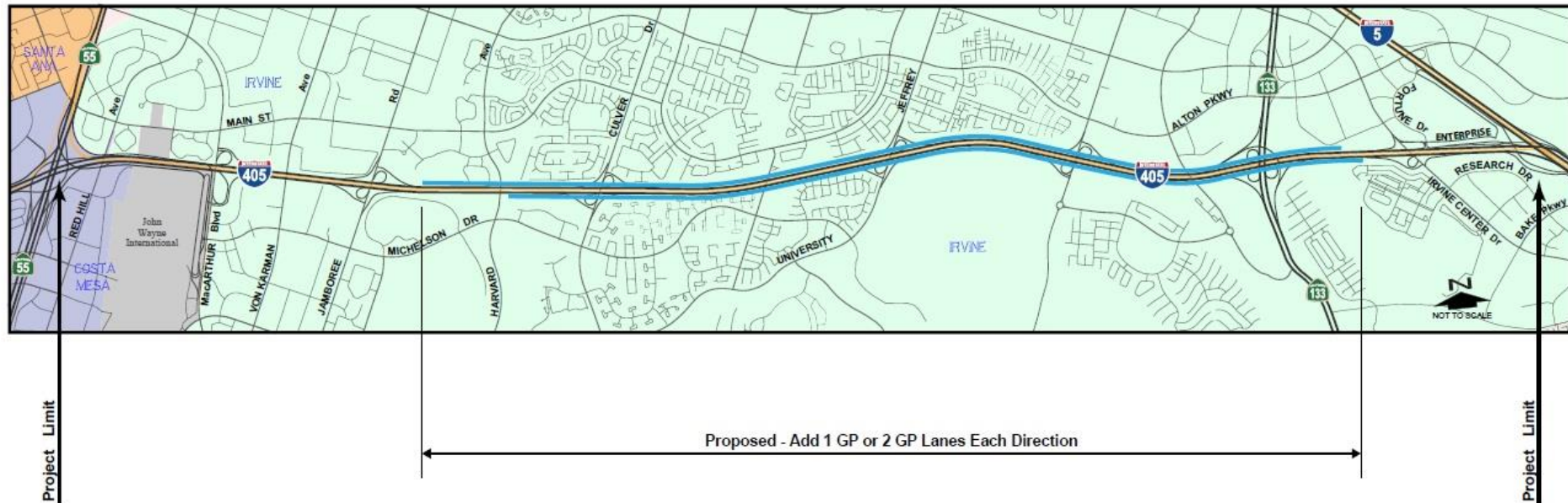

LEGEND

Proposed GP Lanes

Preliminary Alternatives

No Build:

No proposed capital or operational improvements would occur. Assume completion of other programmed improvements currently underway by Caltrans.

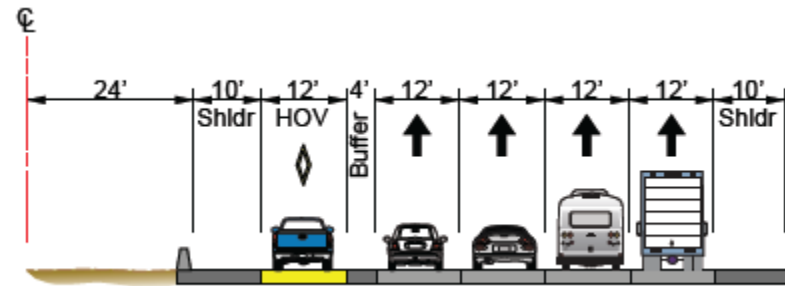

Add One Northbound and Southbound General Purpose Lane

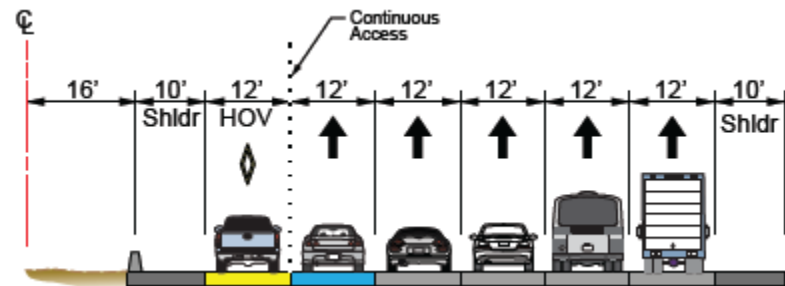

Add Two Northbound and Southbound General Purpose Lanes

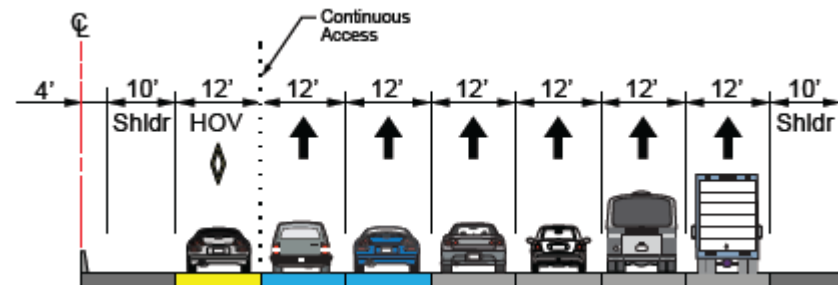

Other Programmed Improvements by Caltrans

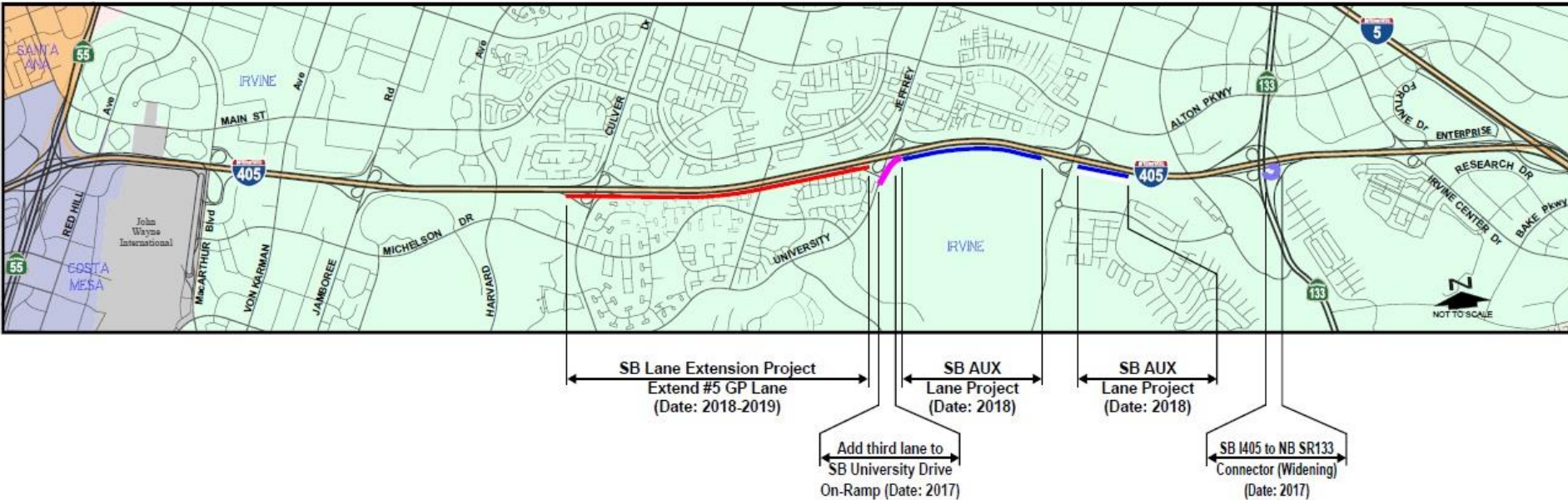

LEGEND

- █ SB Lane Extension Project, 2018-2019
- █ Add Third Lane to SB University Dr On-Ramp, 2017
- █ SB Aux Lane Project, 2018
- █ SB I-405 to NB SR-133 Connector Widening, 2017

Existing Bikeways



I-405 Project - Bikeways

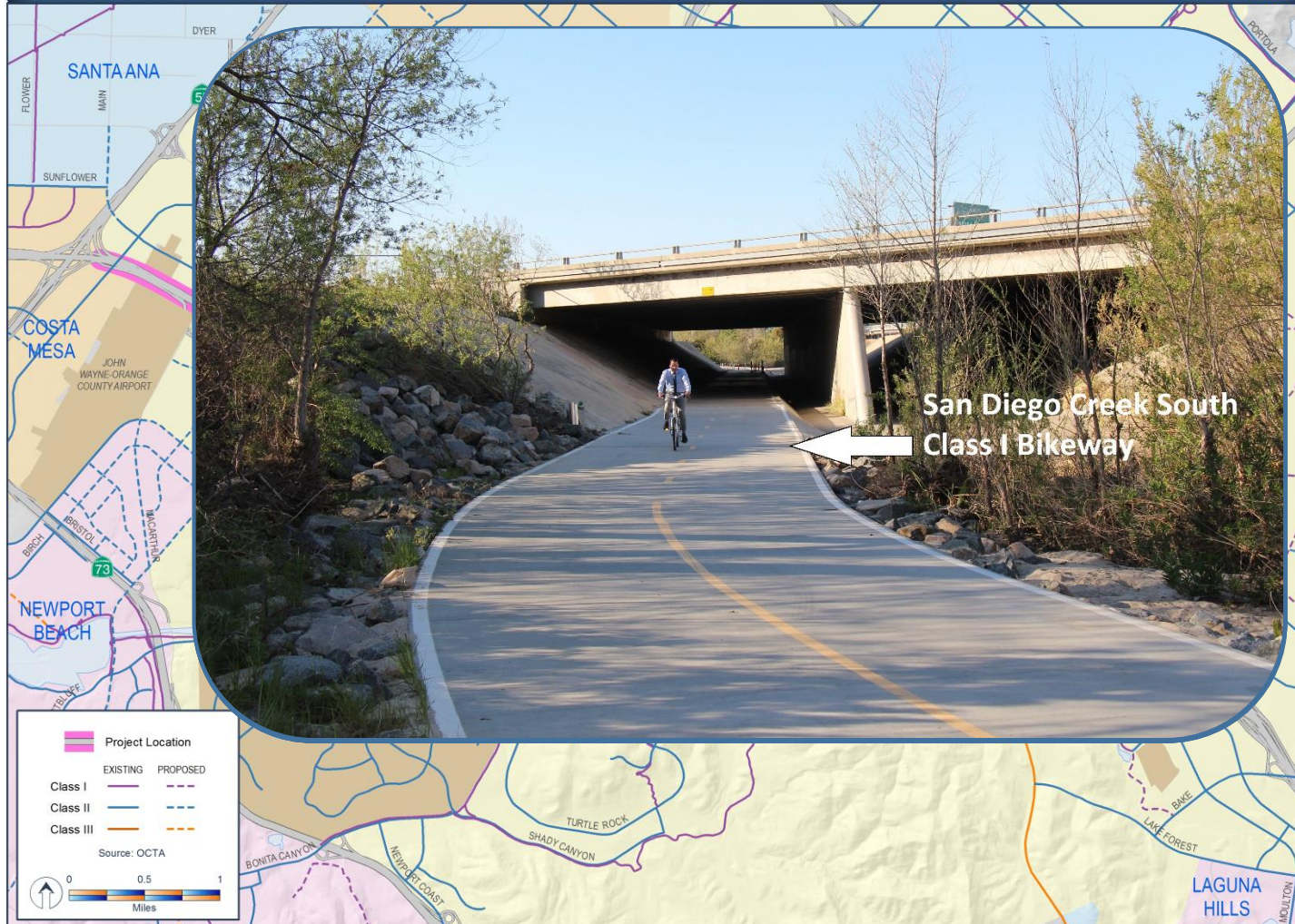



Bike/Ped Safety Features

- Good
- Main



Pote

1.

2.

3.

ramp.

ays

de:
and
SB

ght-

on-



Development Process

Step 1 - Environmental



Nov. 2015: Public Meeting
2015/2016: Tech Studies
Mid 2017:
DED & Open House
Late 2017: FED

Step 2 – Design*



Design NOT funded
No earlier than 2020

Step 3 – Construction*



Construction NOT funded
No earlier than 2023

**Not part of Measure M; no funding currently identified.*

Project Information



Project Website: octa.net/OC405South

The screenshot shows a web browser displaying the OCTA website. The address bar shows the URL: [octa.net/Projects-and-Programs/All-Projects/Freeway-Projects/San-Diego-Freeway-\(I-405\)/I-405-\(I-5-to-SR-55\)/?frm=7336](http://octa.net/Projects-and-Programs/All-Projects/Freeway-Projects/San-Diego-Freeway-(I-405)/I-405-(I-5-to-SR-55)/?frm=7336). The page features the OCTA logo, navigation menus, and a search bar. The main content area displays the project title "I-405 (SR-55 to I-5)" and a contact card for Andrea Hammann. Below the title is a navigation bar with tabs for Overview, Details, Detours, Documents, and Stay Informed. A large photograph of a multi-lane highway with heavy traffic is shown at the bottom.

octa.net/Projects-and-Programs/All-Projects/Freeway-Projects/San-Diego-Freeway-(I-405)/I-405-(I-5-to-SR-55)/?frm=7336

HIGH CONTRAST CAREERS CONTACT US Select Language f t i s e

OCTA Getting Around Projects and Programs News and Resources About OCTA Search OCTA

Home All Projects Freeway Projects San Diego Freeway (I-405) I-405 (I-5 to SR-55)

PROJECT CONTACTS 1 of 2

ANDREA HAMMANN
(714) 560-5573
ahammann@octa.net

Overview Details Detours Documents Stay Informed

I-405 (SR-55 to I-5)

Jamboree Rd
EXIT ONLY